

DEXTER S3

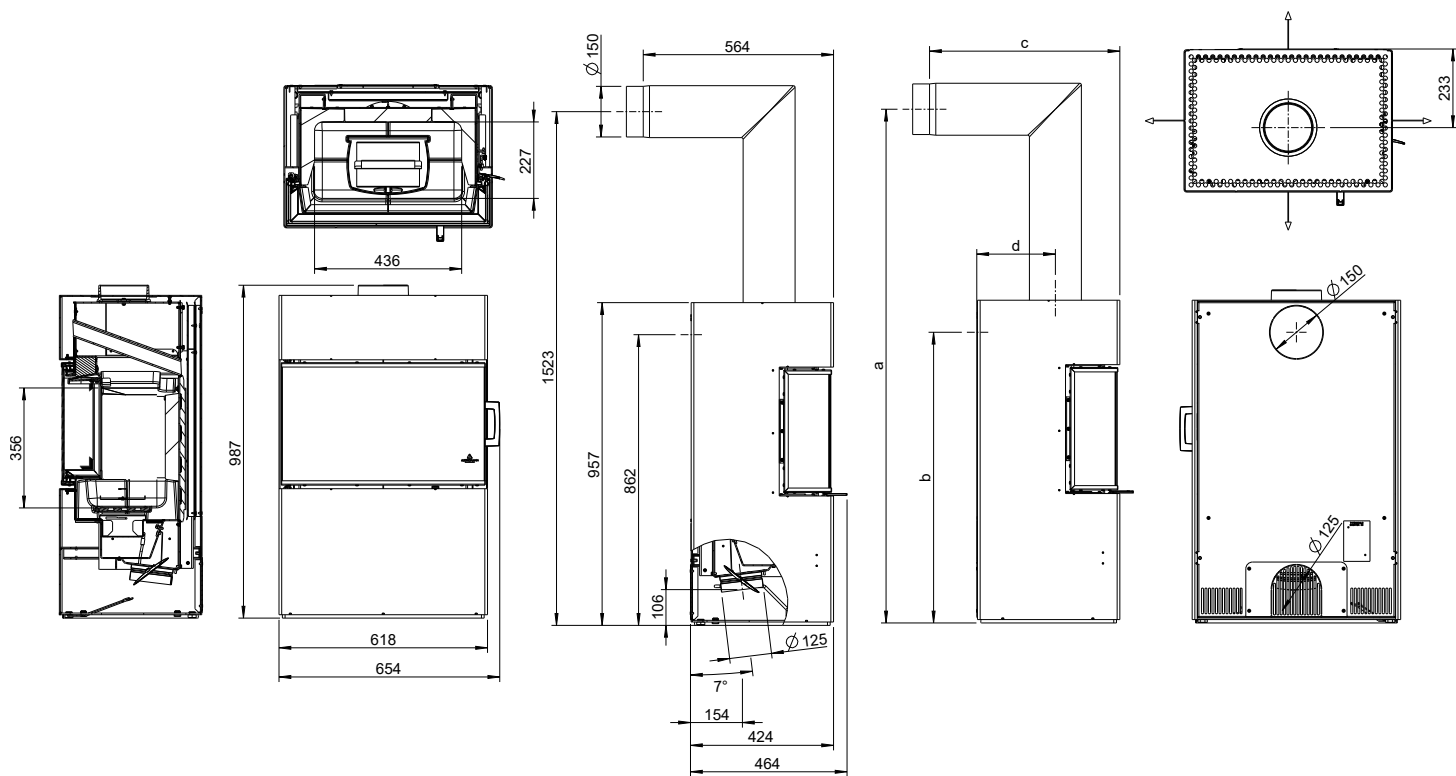

AUSTROFLAMM



Dimensions and weight

| | |
|---|------|
| Height [mm] | 957 |
| Width [mm] | 618 |
| Depth [mm] | 424 |
| Combustion chamber width [mm] | 436 |
| Combustion chamber height [mm] | 356 |
| Combustion chamber depth [mm] | 227 |
| Baking compartment width [mm] | - |
| Baking compartment height [mm] | - |
| Baking compartment depth [mm] | - |
| Warming drawer, width [mm] | - |
| Warming compartment height [mm] | - |
| Warming drawer, depth [mm] | - |
| Dimensions, a (with Austroflamm elbow piece) [mm] | 1523 |
| Dimensions, b (with Austroflamm elbow piece) [mm] | 862 |
| Dimensions, c (with Austroflamm elbow piece) [mm] | 564 |
| Dimensions, d (with Austroflamm elbow piece) [mm] | 233 |
| Flue pipe outlet, diameter [mm] | 150 |
| Outside air connection diameter [Ø mm] | 125 |
| Weight, basic appliance [kg] | 164 |
| Weight Xtra [kg] | - |
| Weight, HMS [kg] | 51 |
| Total weight inc. steel case (STM) [kg] | 164 |
| Total weight inc. ceramic case (KGM) [kg] | - |
| Total weight inc. soapstone case (SPM) [kg] | - |
| a: Safety distance to combustible materials, front [mm] | 1100 |
| b: Safety distance to combustible materials, left [mm] | 600 |
| c: Safety distance to combustible materials, rear [mm] | 150 |
| d: Safety distance to combustible materials, right [mm] | 600 |
| Safety distance to combustible materials, floor [mm] | 0 |
| Minimum distance from non-flammable materials [mm] | 50 |

Output

| | |
|------------------------------------|-----|
| Nominal heat efficiency [kW] | 6.0 |
| Minimum heat output [kW] | 3.5 |
| Maximum heat output [kW] | 8.0 |
| Minimum room heating capacity [m³] | 65 |
| Maximum room heating capacity [m³] | 165 |
| Energy efficiency class | A |

Data for the chimney sweep

| | |
|---|------|
| Exhaust gas mass flow [g/s] | 6.41 |
| Flue gas temperature [°C] | 302 |
| Minimum delivery pressure at nominal heat output [Pa] | 12 |
| at 0.8 times nominal heat output [Pa] | 10 |

Equipment

| | |
|--|-------------|
| Xtra heat storage technology | - |
| Heat Memory System | Accessories |
| External air connection / operation independent of ambient air | Yes |
| Ash removal | Ash box |

- not available